



Attachment B





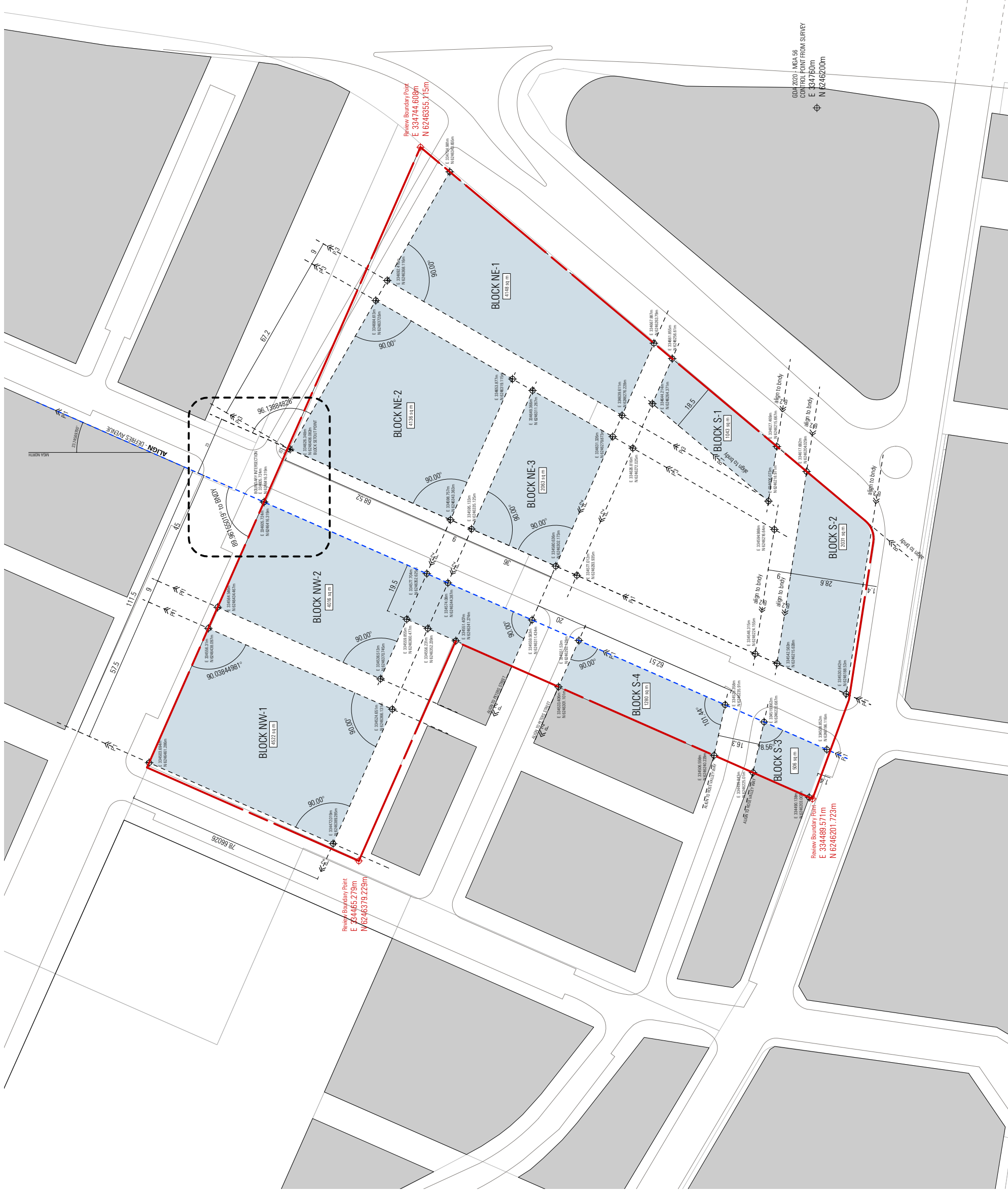
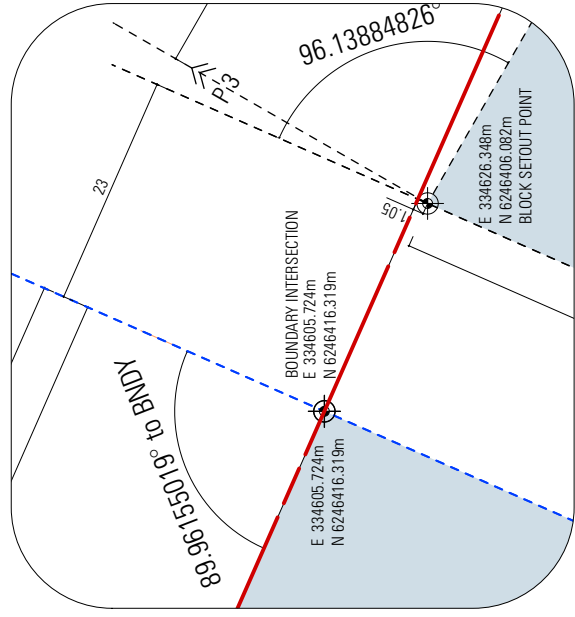

Building Envelope Drawings

LEGEND

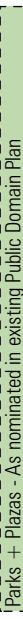
-  Block Setout
-  Block Area





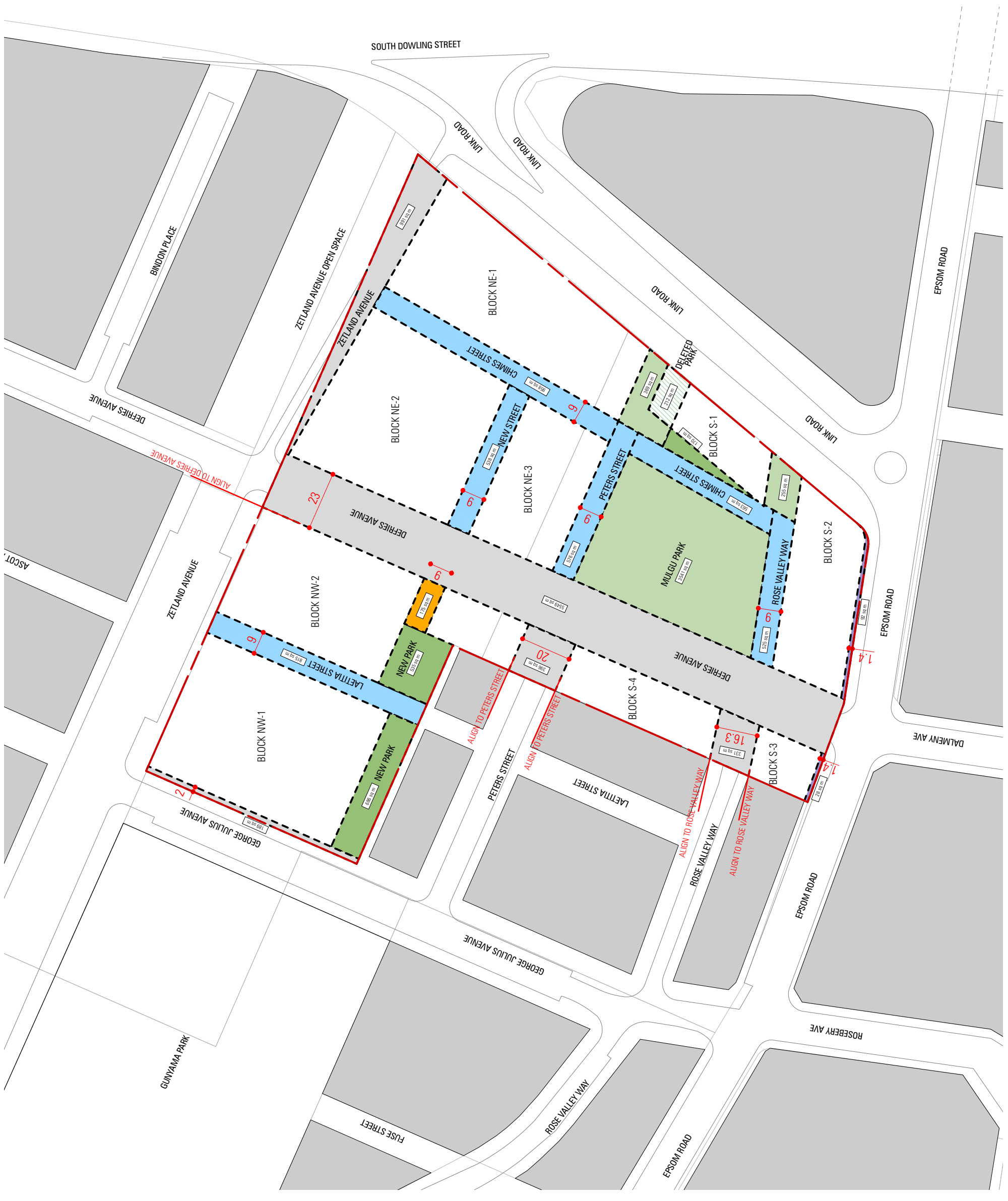

LEGEND

-  Parks + Plazas - As nominated in existing Public Domain Plan
-  Parks + Plazas - Removed from existing Public Domain Plan
-  Parks + Plazas - Additional
-  Streets - Vehicular
-  Streets - Shared Zones
-  Easements with Through-Block Links
-  Footpath Widening Dedication



LEGEND

	Dedication - Public
	Dedication - Stratum
	SUB TOTALS
	Public Dedication 13,528 sqm
	Stratum Dedication 3,753 sqm
	TOTAL
	17,281 sqm

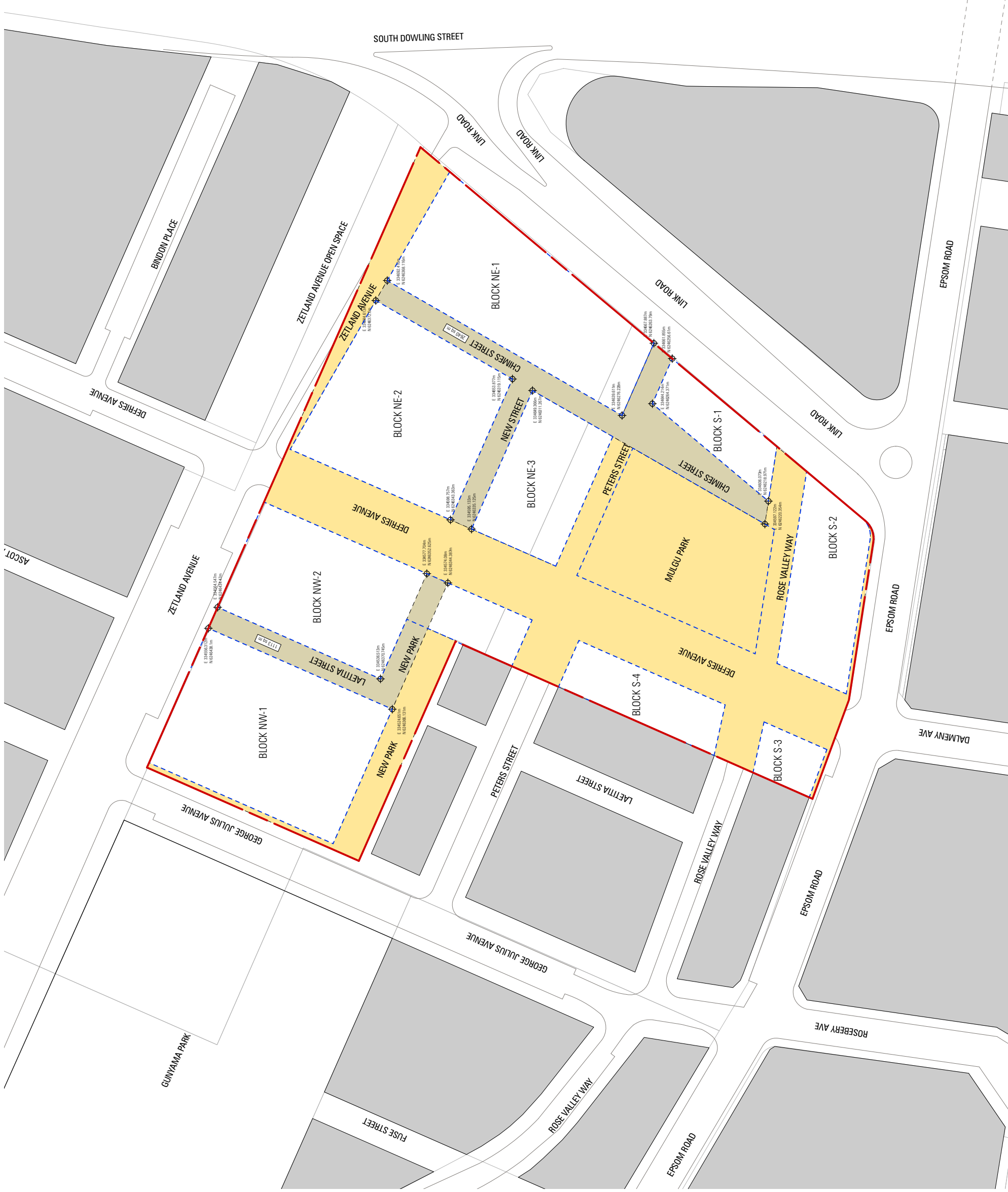

LEGEND

- North East Stage
- South Stage
- North West Stage
- Delivered as part of North East Stage but precedes South Stage

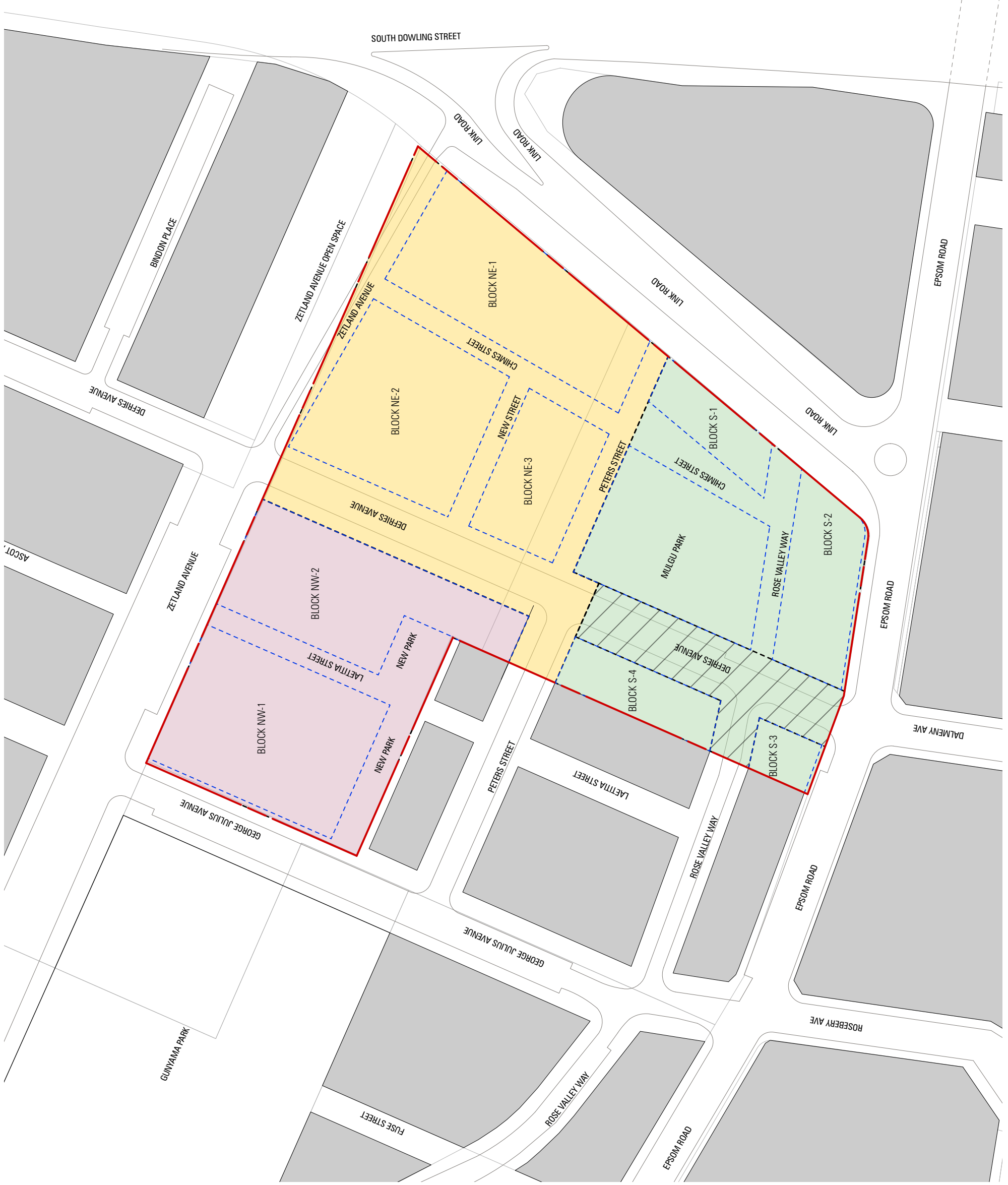

LEGEND

- North East Stage
- South Stage
- North West Stage
- Delivered as part of North East Stage but precedes South Stage

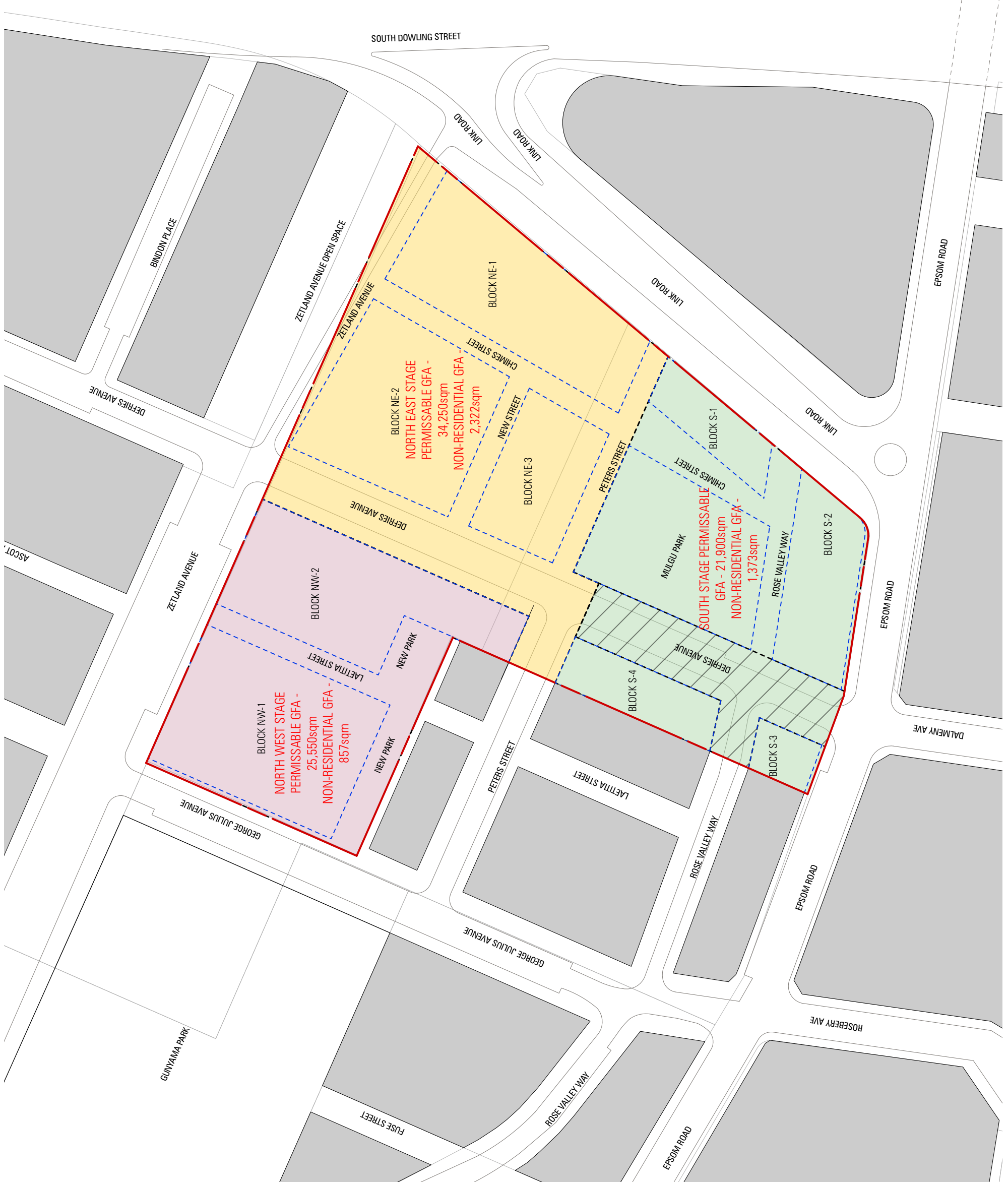

LEGEND

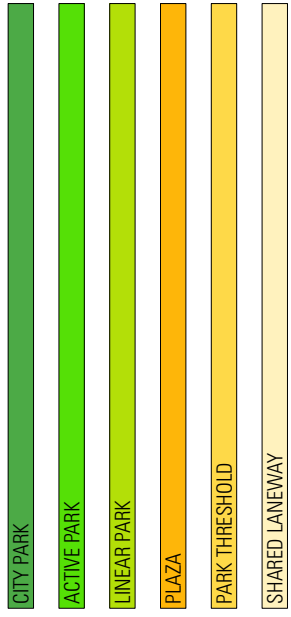

LEGEND

DEEP SOIL PLANTING AREAS

STAGE	SITE AREA	DEEP SOIL AREA	PERCENTAGE
NORTH EAST	17,170 sqm	527 sqm	3%
SOUTH	12,916 sqm	3,541 sqm	27%
NORTH WEST	10,761 sqm	1,019 sqm	9%
TOTAL	40,847 sqm	5,086 sqm	12%



LEGEND

- Setback - 0.0.0m
- Setback - 0.1.0m
- Setback - 0.1.5m
- Setback - 0.2.0m
- Setback - 0.2.5m
- Setback - 0.3.0m
- Setback - 0.3.3m
- Setback - 0.4.0m
- Setback - 0.4.5m

Setback -  Align with neighbouring building at all levels



LEGEND

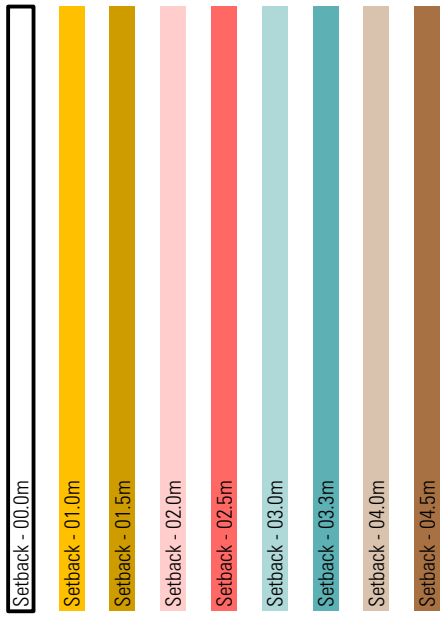

LEGEND

- USE - Other than Residential
- USE - Other than Residential - or - Communal Open Space.
(excludes car parking or vehicular servicing)
- USE - Residential
- USE - Servicing + Parking Access
- USE - Indicative Residential Lobby Location
- Pedestrian Access
- Vehicle Access

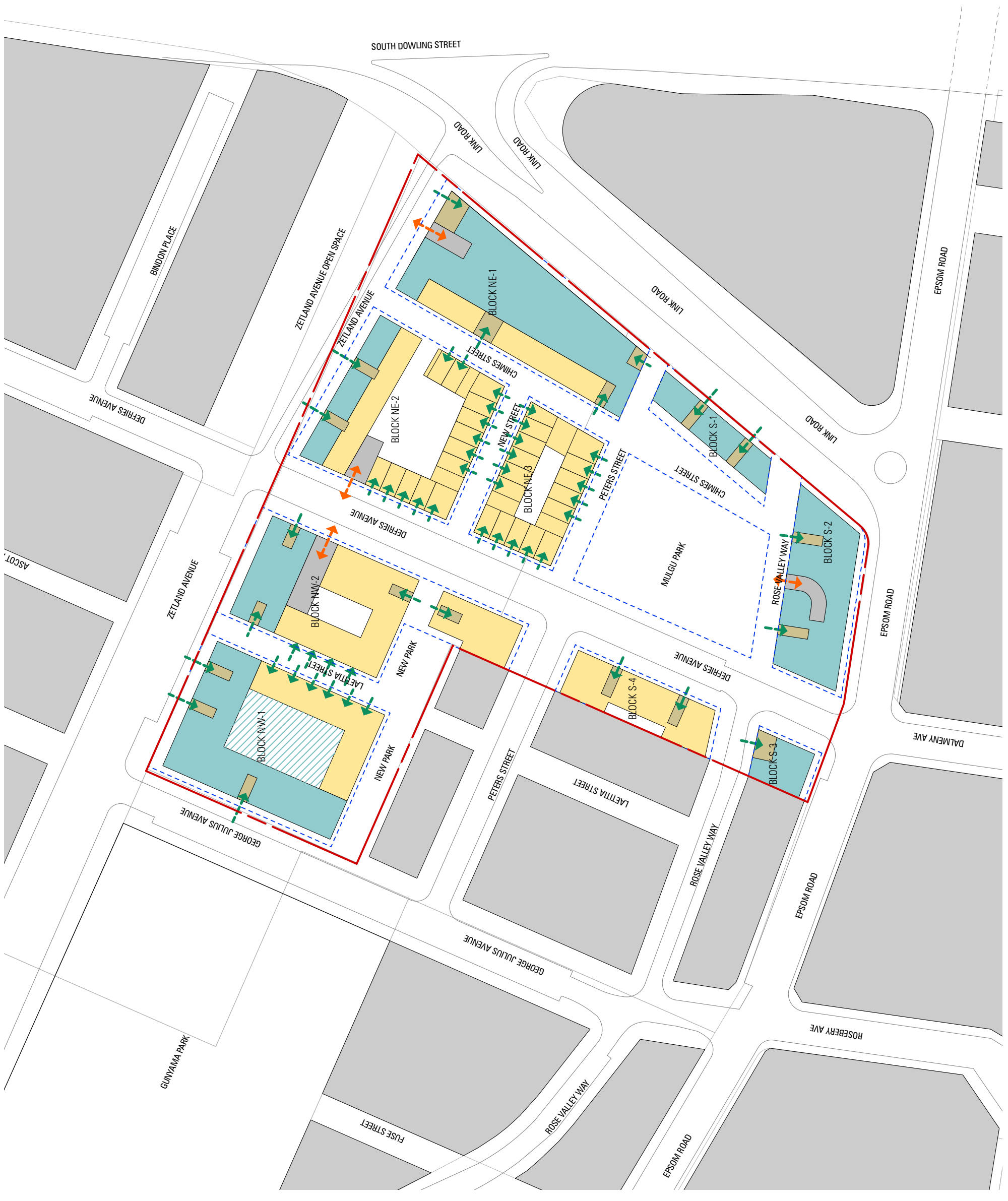

LEGEND

- Basement Area
- Area of Basement Beneath Public Domain
- Deep Soil Pocket Locations

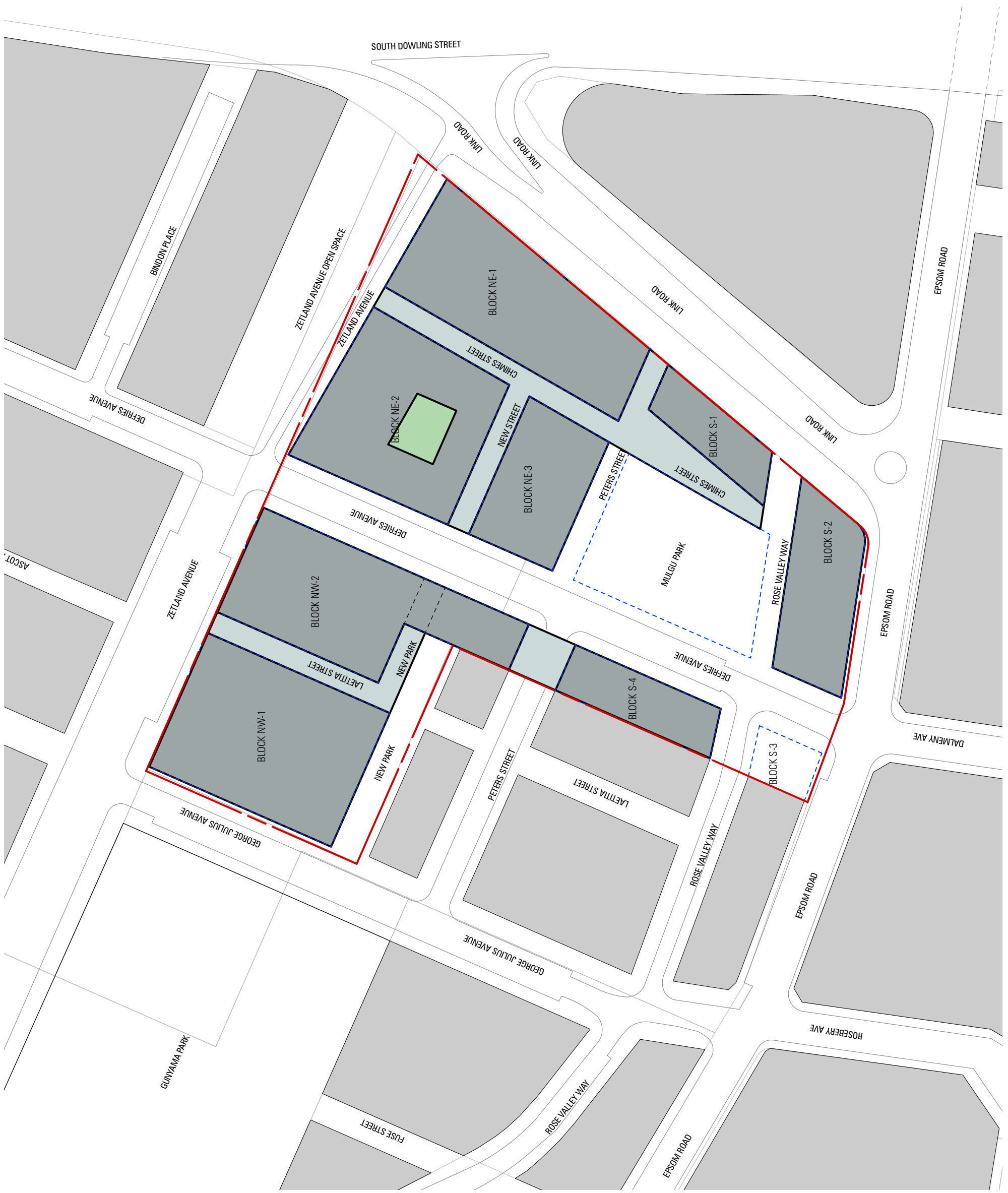

LEGEND

- 01 - Storeys
- 02 - Storeys
- 03 - Storeys
- 04 - Storeys
- 05 - Storeys
- 06 - Storeys
- 07 - Storeys
- 08 - Storeys
- 09 - Storeys
- 10 - Storeys
- 12 - Storeys
- 14 - Storeys
- 15 - Storeys
- 20 - 25 - Storeys
- Hatched Tower Zone
- Zoen's A, B, C - Tower may be located anywhere within this zone up to the maximum floor plate defined in 5.3.6.4(3)
- Solar Zone
- Area that may be occupied only subject to:
- Achieving ADG solar access compliance for Block S-4
- Achieving 75% 4 hours solar access to Mulgu Park (June 21)
- Basement Connection
zones of under street connections between basements
- 5
- Top Floor Setback - Figured Dimension as Shown
- Number of Storeys
- Maximum number of storeys that may be used for retail.
Otherwise no storeys permitted (0)
- 1R (0)
- Vehicle Entry - AND - Exit Locations
- Vehicle One Way Entry - OR - Exit Locations
- Deep Soil Areas

